

Product Code	Description
HC2771	6A 250V 1 Gang Blind Switch (Logo - Up/Down)



HC2771-SBL



Product back view

## Technical Specification

- Rated Voltage: 250V, 50/60Hz
- Rated Current: 6AX
- Recommended wire size: 1.0mm<sup>2</sup> - 2.5mm<sup>2</sup>
- Dimensions: 86 x 86 x 10mm (WxHxD)
- Fix Center: 60.3 mm
- Fix Screw: M3.5 x 0.6 x 30mm±
- Mounting box: >47mm depth
  - R1150, flush mounting, plastic (80 x 80 x 48.4mm) (WxHxD)
  - M1247, flush mounting, metal (79 x 73 x 47mm) (WxHxD)
- Comply to standards:
  - BS EN 60669-1
  - IEC 60669
  - GB/T 16915.1



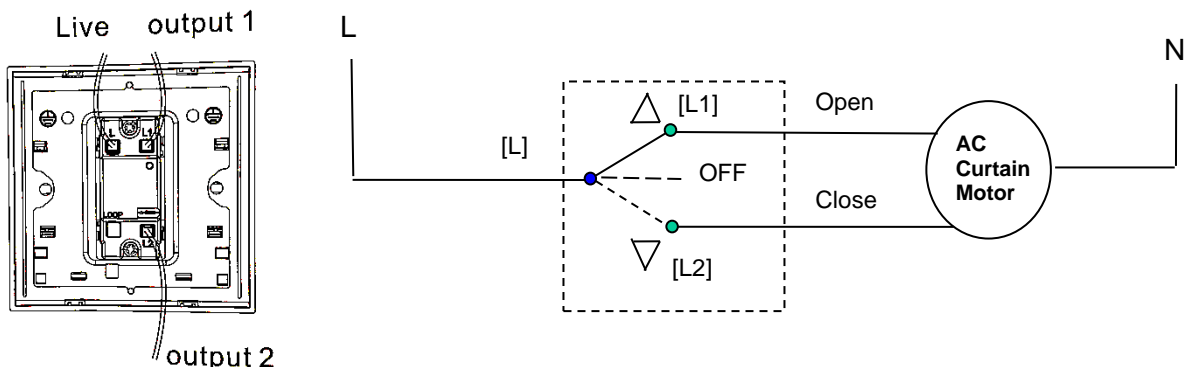

## Typical Wiring:

3-Position Switch (L1 - Off - L2)

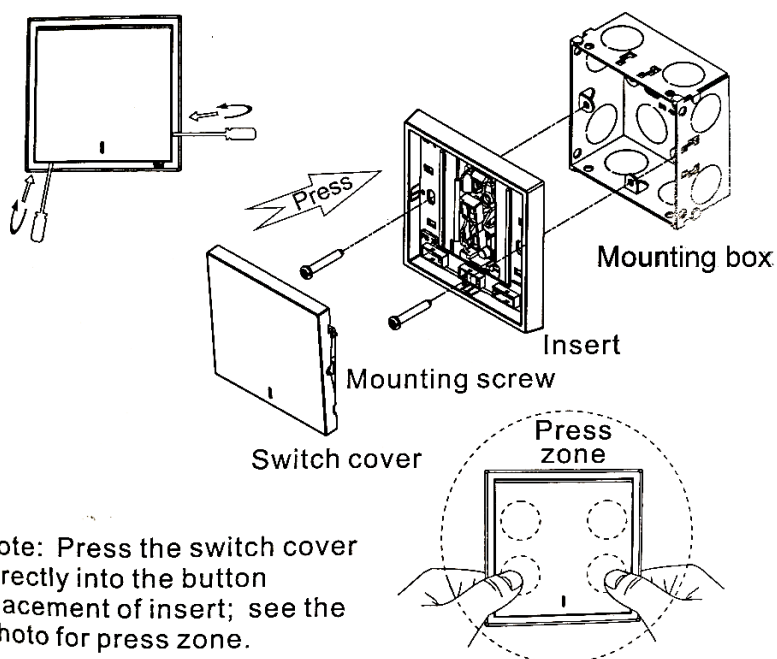

## Installation Method



Product Code	Colour
HC2771	 White
HC2771-SBL	 Matt Black (SBL)
HC2771-MSB	 Matt Silver Black (MSB)
HC2771-PS7	 Dark Champagne (PS7)
HC2771-ST5	 Champagne Grey (ST5)
For other colours, please contact T&J Sales representative	

Multi-Gang Adaptor Frames			Product Dimension Scale: mm
